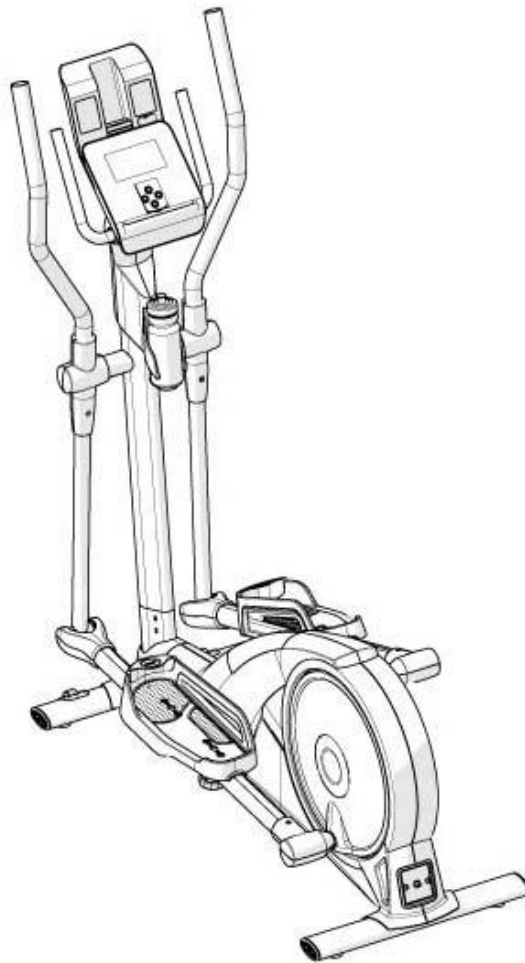
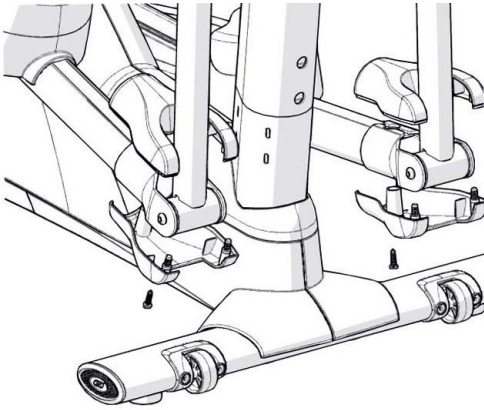


# YOWZA

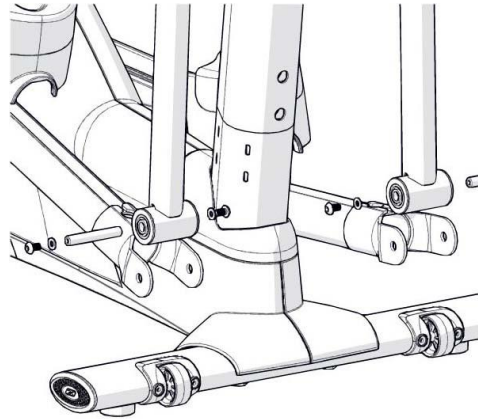
*SERVICE MANUAL FOR:  
LARGO / C5.8Y*



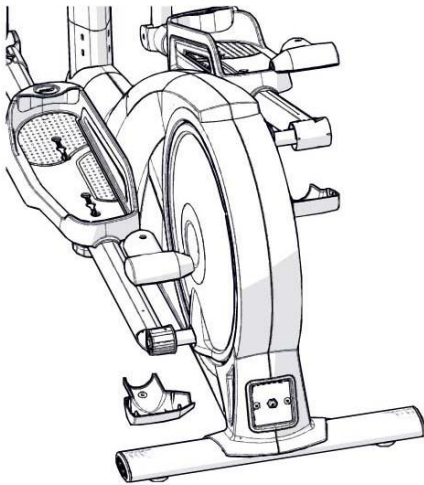
## Open both side cover



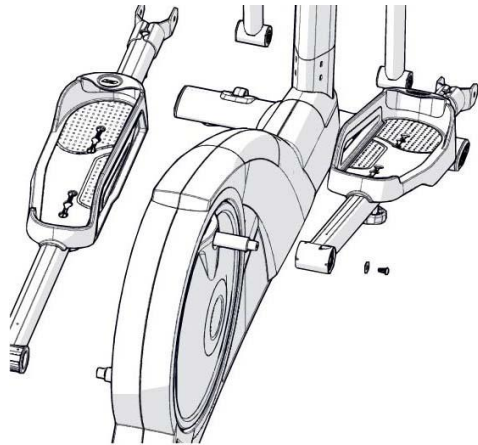
**Step 1:** Use Phillip screwdriver remove 4 piece Front Foot Plate Tube Front Covers.



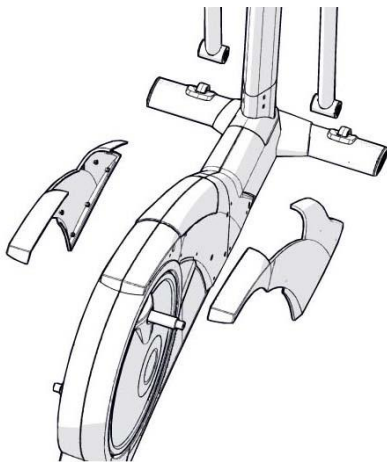
**Step 2:** Use 2 piece 5mm Allen wrench remove both side Foot Plate Tube Sleeves.



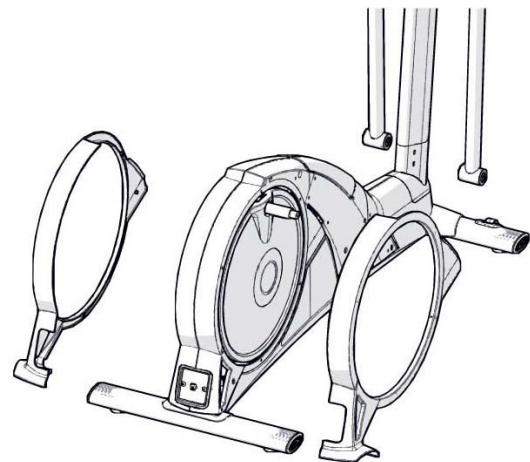
**Step 3:** Use Phillip screwdriver remove 4 piece Rear Foot Plate Tube Rear Covers.



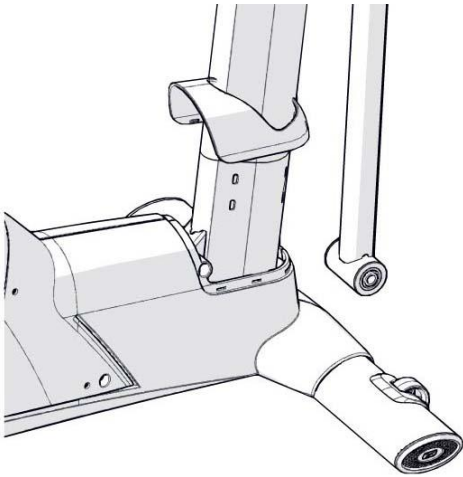
**Step 4:** Use 10mm socket wrench remove both Foot Plate Tube set.



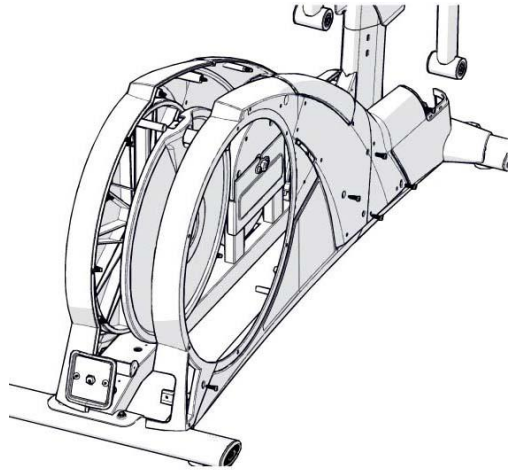
**Step 5:** Use both hands carefully remove both Side Chain Covers-Front.



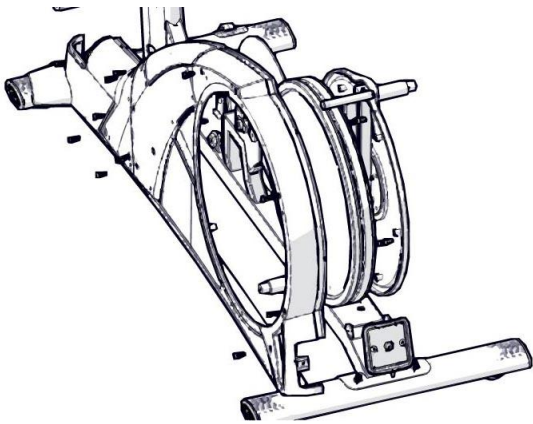
**Step 6:** Use both hands carefully remove both Side Chain Covers-Rear.



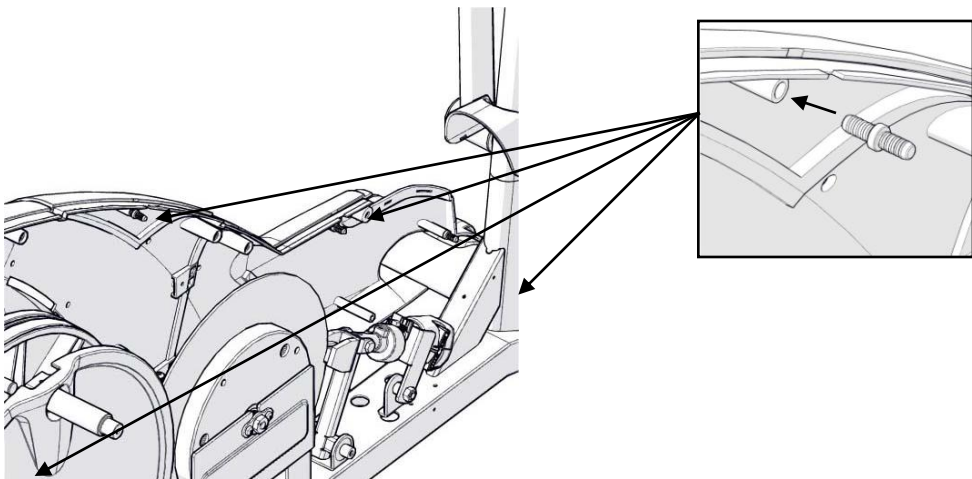
**Step 7:** Move up Upright Lower Cover .



**Step 8:** Use Phillip screwdriver remove right side Front Chain Cover and Main Chain Cover.



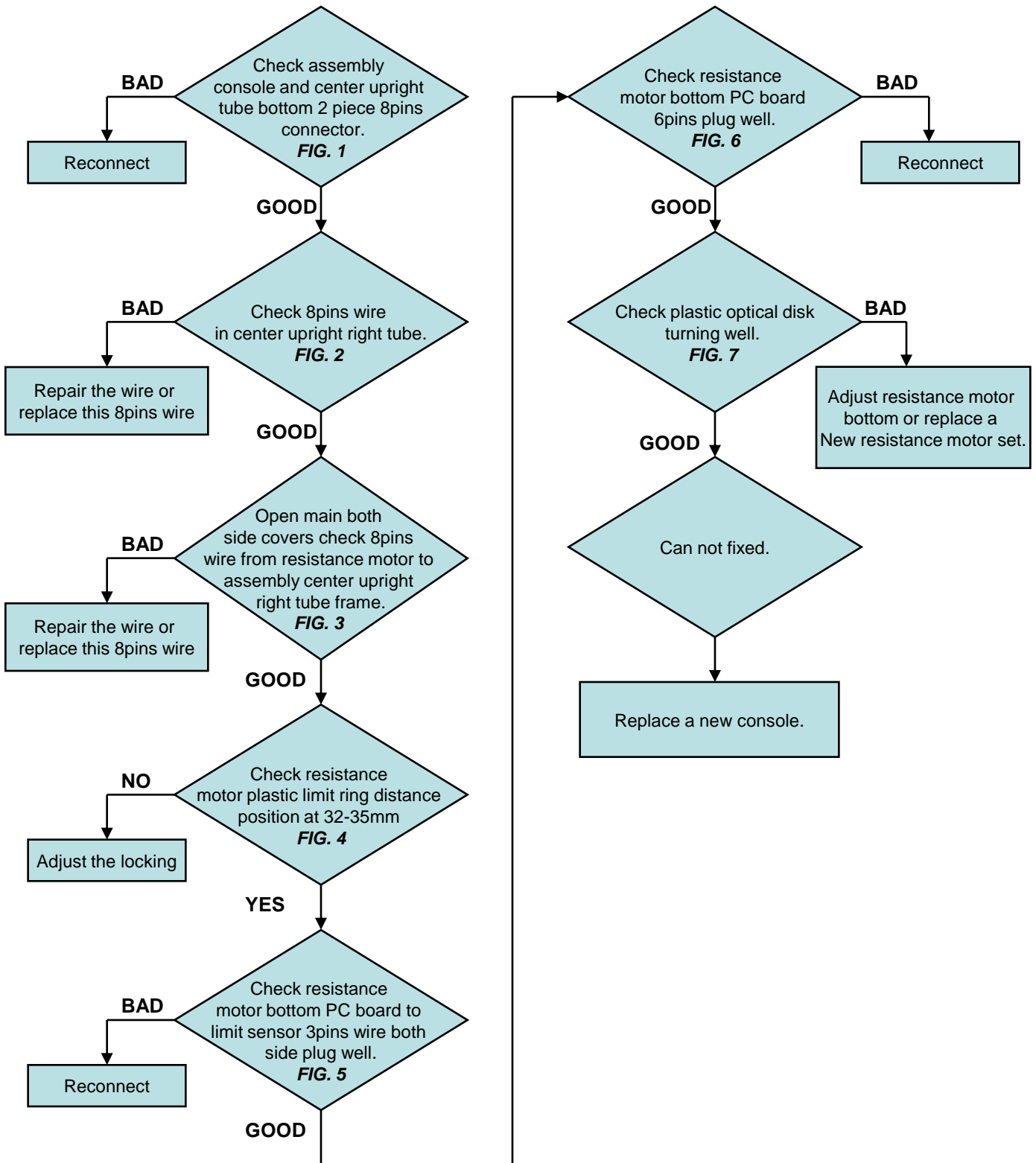
**Step 9:** Use Phillip screwdriver remove left side Front Chain Cover and Main Chain Cover.



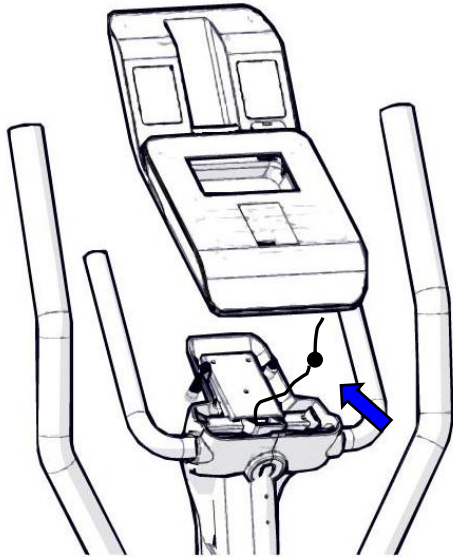
**NOTE:** When assembly back Main Chain Covers, must confirm plastic bolt be install.

# Trouble Shooting

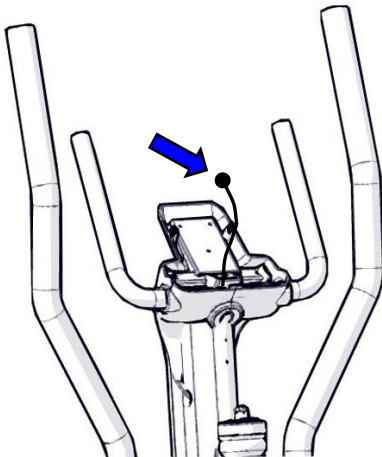
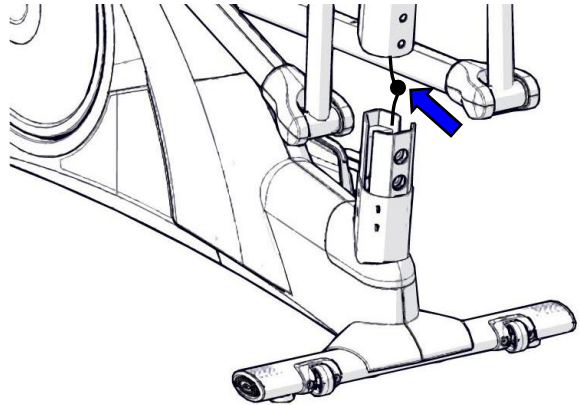
## Computer display "0" blinking and button doesn't work-1



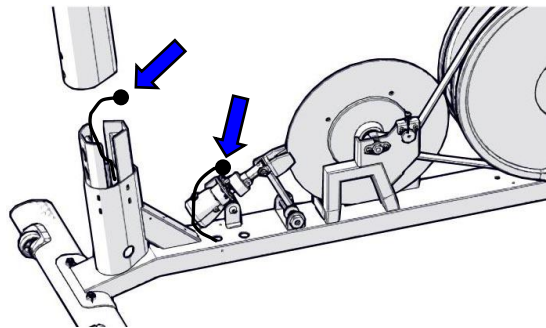
## Computer display “0” blinking and button doesn't work-2



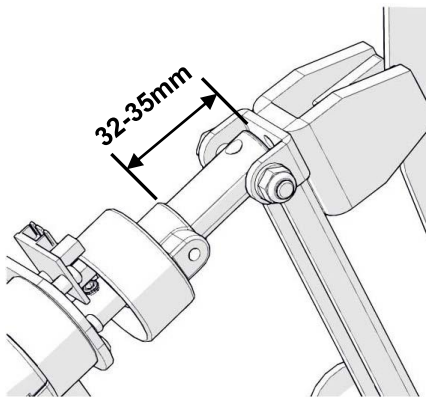
**FIG. 1 :** Check assembly console and center upright tube bottom 2 piece 8pins connector.



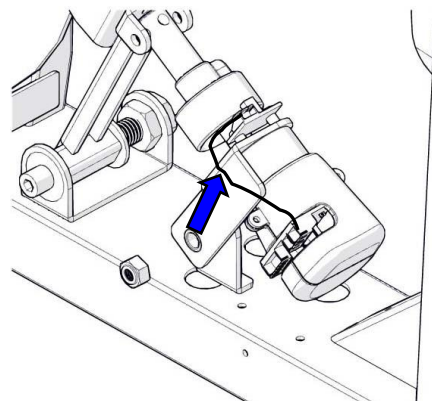
**FIG. 2 :** Pull out 8pins wire from center upright right tube then check it whole wire.



**FIG. 3 :** Follow open main cover instruction to move out both side covers then pull out and check 8pins wire from resistance motor to assembly center upright right tube frame.

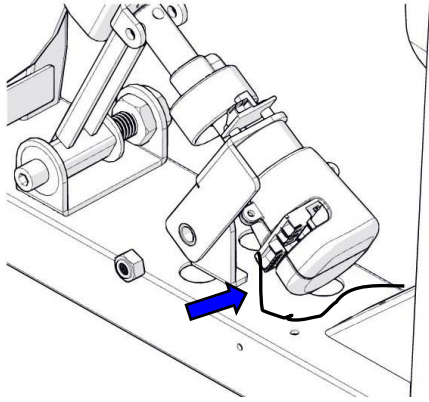


**FIG. 4 :** Check resistance motor plastic limit ring distance position at 32-35mm

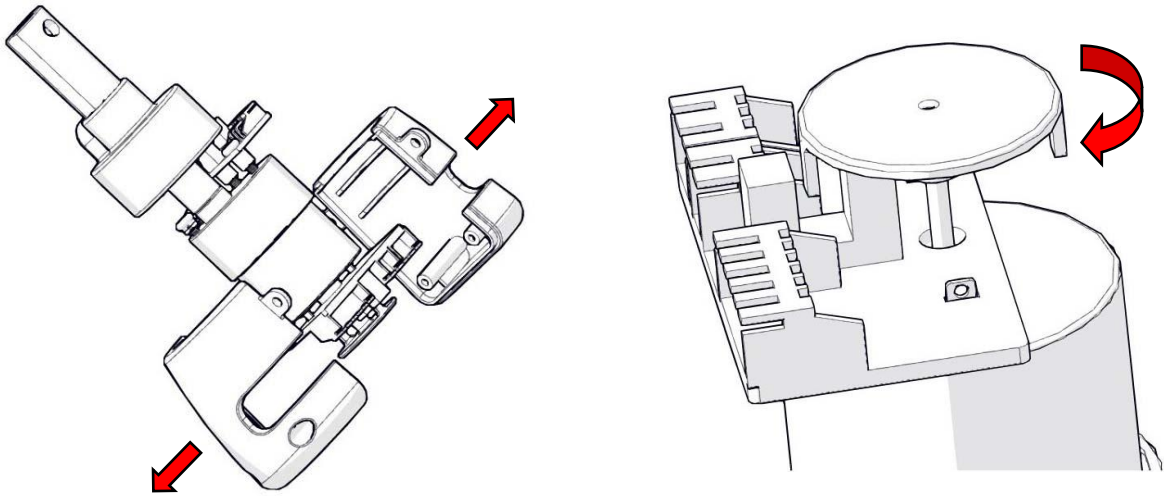


**FIG. 5 :** Check resistance motor bottom PC board to limit sensor 3pins wire both side plug well.

## Computer display "0" blinking and button doesn't work-3



**FIG. 6:** Check resistance motor bottom PC board 6pins plug well.



**FIG. 7:** Use Phillip screwdriver to open resistance motor set both covers then use finger to turning plastic optical disk check this disk turning well.

## Service and Engineering mode function

### Convert English (MPH) / Metric (KM/H)

Console at power on status, press STOP and RESISTANCE UP button and hold for 3 seconds, console will display “MPH” or “KM/H”, use RESISTANCE UP and DOWN button to select between “MPH” and “KM/H” then press ENTER button to confirm select.

### Enter To Engineering Mode and display computer software version

Console at power on status first press STOP button and hold it, then press MODE button hold for 3 seconds too, console will show “E1.x” is computer software version and “1” then use RESISTANCE UP and DOWN button to select “1, 2, 3, 4 then press START button to enter.

#### 1: Display and change manufactory date

This function console can display manufactory date, After select “1” if just check then direct press ENTER button still console return to power on status or press START button and use RESISTANCE UP and DOWN button to adjust then press ENTER button to confirm and return power on status.

#### 2: Chang resistance range

This function can change resistance range, if user feel resistance too high or too lower at level16, after select “2” then press START button to enter, console will display “Lo” and value number “0”, press ENTER button then console will display “Hi” and value number “XXX” is manufactory default, use RESISTANCE UP and DOWN can adjust resistance level 16 higher or lower then press ENTER twice return power on status.

#### 3: Display total distance

After select “3” then press START button to enter, console will display total used distance, if just check press ENTER button twice return power on status, or press RESISTANCE DOWN to reset to “0” then press ENTER button twice return power on status.

#### 4: Display total time

After select “4” then press START button to enter, console will display total used time, if just check press ENTER button twice return power on status, or press RESISTANCE DOWN to reset to “0” then press ENTER button twice return power on status.