

Open both side cover

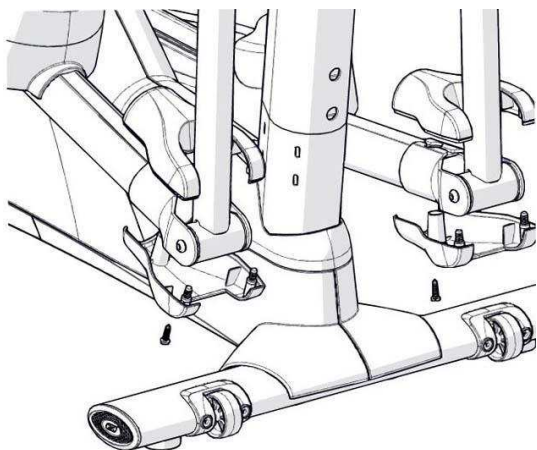

Step 1: Use Phillip screwdriver remove 4 piece Front Foot Plate Tube Front Covers.

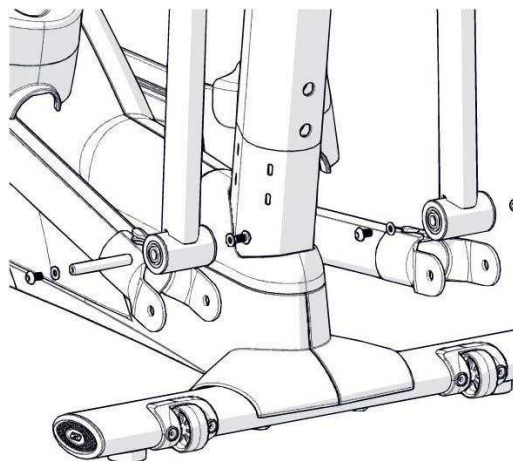

Step 2: Use 2 piece 5mm Allen wrench remove both side Foot Plate Tube Sleeves.

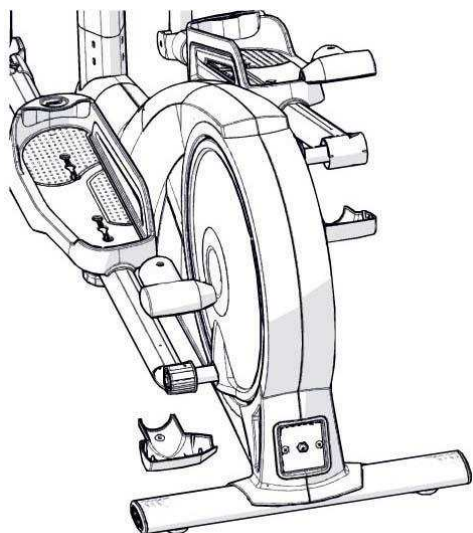

Step 3: Use Phillip screwdriver remove 4 piece Rear Foot Plate Tube Rear Covers.

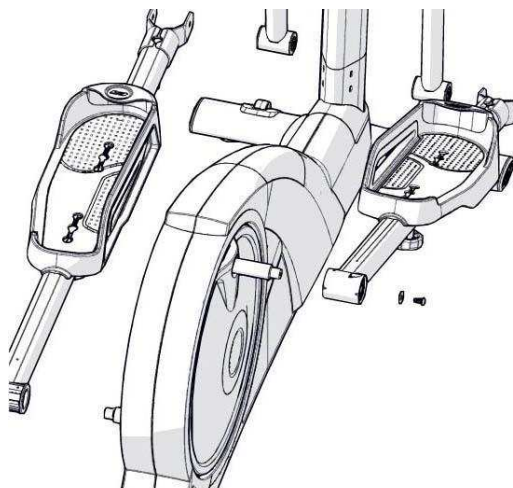

Step 4: Use 10mm socket wrench remove both Foot Plate Tube set.

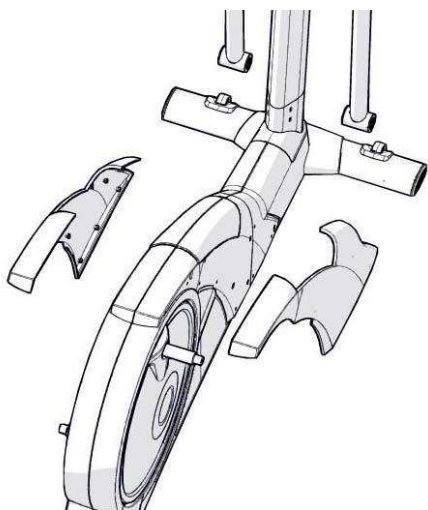

Step 5: Use both hands carefully remove both Side Chain Covers-Front.

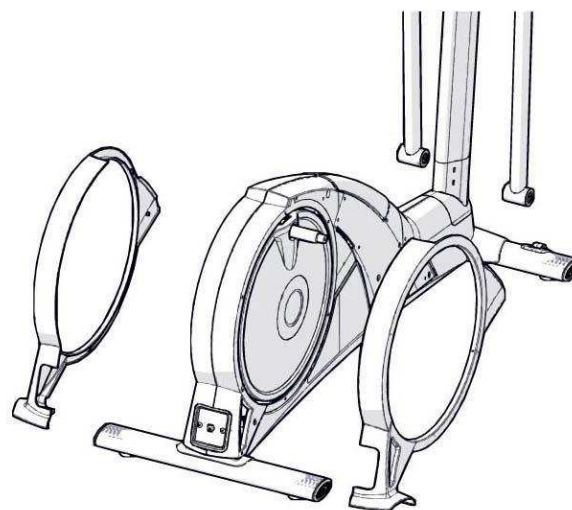

Step 6: Use both hands carefully remove both Side Chain Covers-Rear.

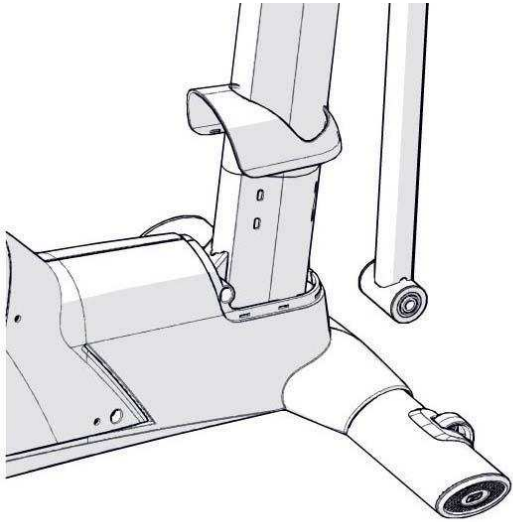

Step 7: Move up Upright Lower Cover .

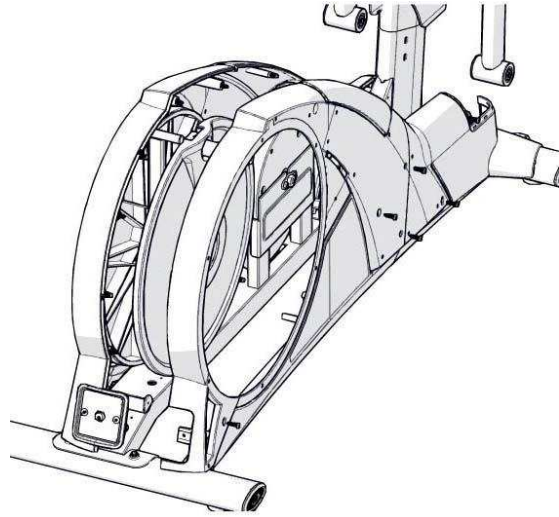

Step 8: Use Phillip screwdriver remove right side Front Chain Cover and Main Chain Cover.

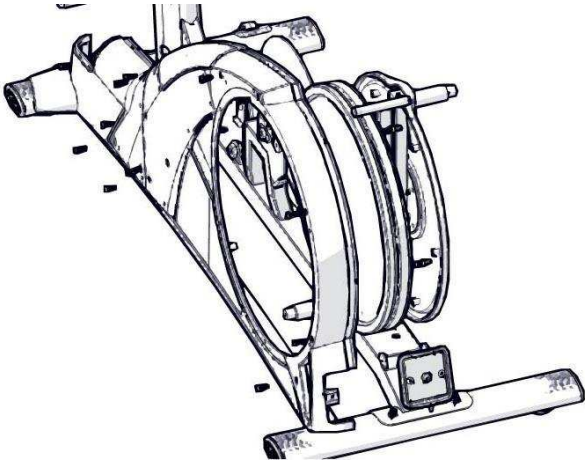

Step 9: Use Phillip screwdriver remove left side Front Chain Cover and Main Chain Cover.

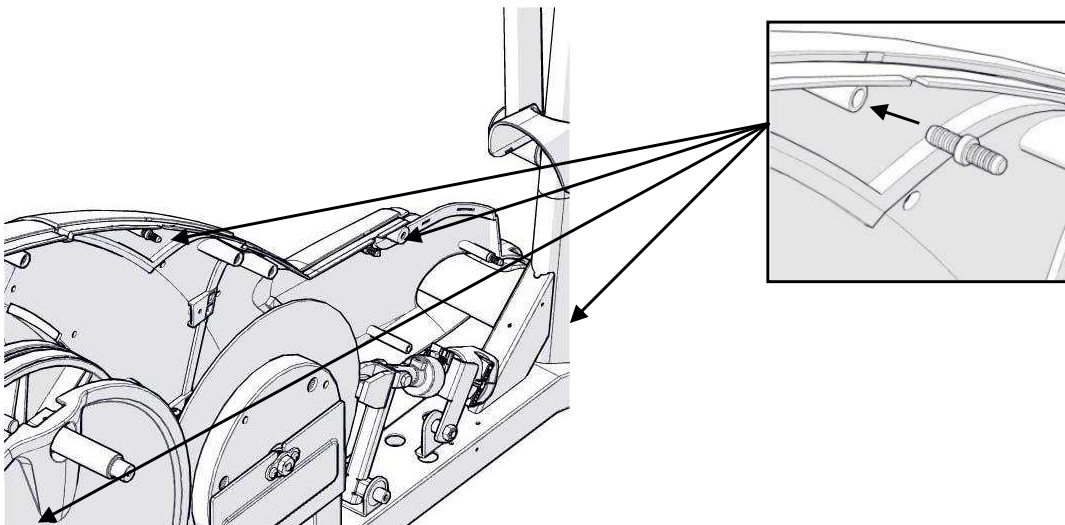

NOTE: When assembly back Main Chain Covers, must confirm plastic bolt be install.

Computer display “0” blinking and button doesn’t work-2

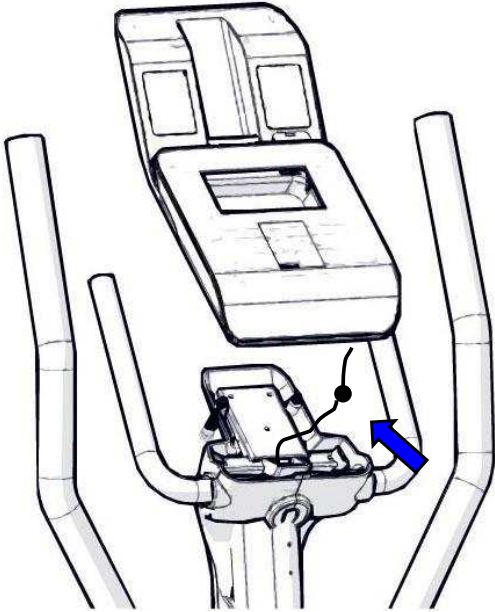

FIG. 1 : Check assembly console and center upright tube bottom 2 piece 8pins connector.

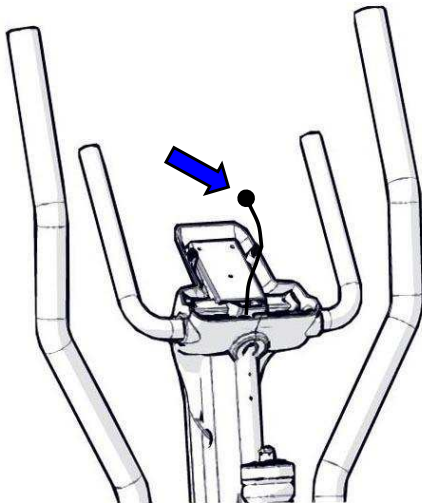
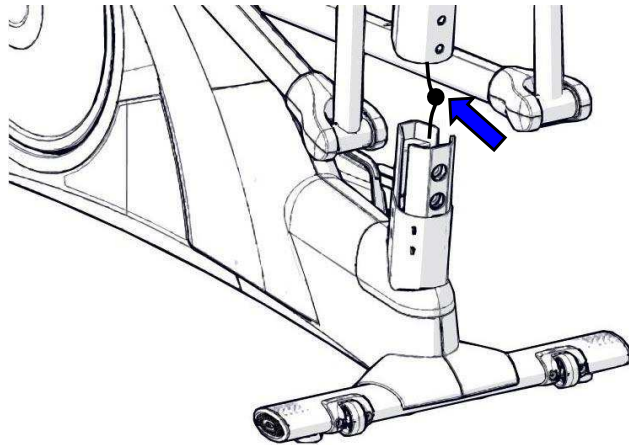

FIG. 2: Pull out 8pins wire from center upright right tube then check it whole wire.

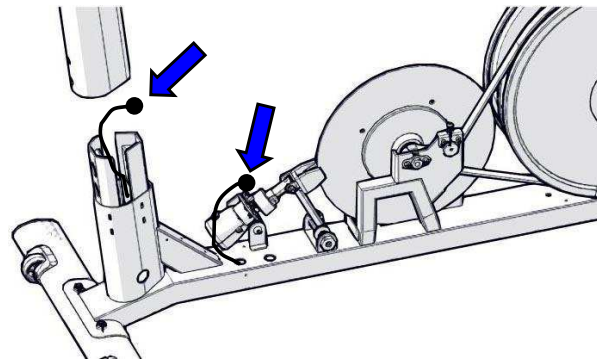

FIG. 3 : Follow open main cover instruction to move out both side covers then pull out and check 8pins wire from resistance motor to assembly center upright right tube frame.

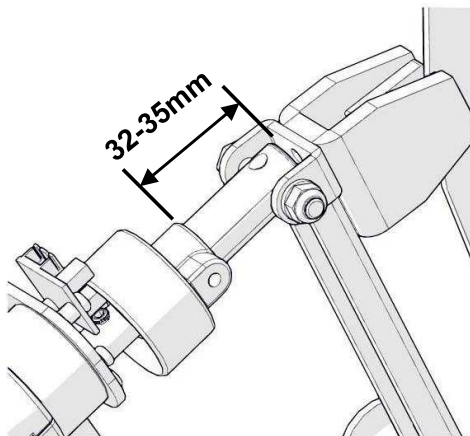

FIG. 4: Check resistance motor plastic limit ring distance position at 32-35mm

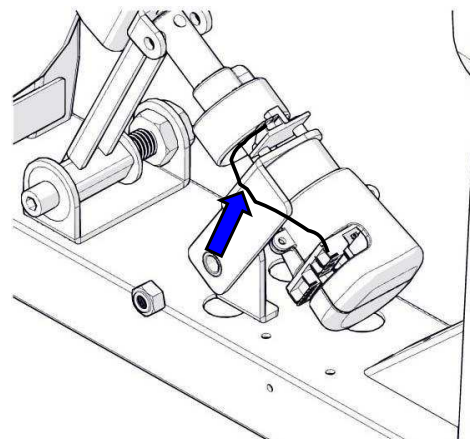

FIG. 5: Check resistance motor bottom PC board to limit sensor 3pins wire both side plug well.